

**GENERAL NOTES**

Refer to floor plans for position and handing of flats - this drawing indicates setting out of individual flats only.

All internal partitions within flats to be 70mm metal stud partitions; sound deadening quilt to be fixed between metal studs of partitions around Shower Rooms; 19mm plywood to be fixed behind plasterboard wherever grab rails or any other load-bearing fixtures are required.

All dimensions measured to face of brickwork, blockwork and metal frame.

SVPs passing vertically through compartment floors to be firestopped. SVPs to terminate at tile vents - drainage design to be determined by Structural Engineer.

Refer to M&E Consultants package for information relating to services

Refer to large scale bathroom and kitchen layouts for detailed information.

Refer to internal door schedule, window schedule and screen schedule for additional information.

**Note:**

Fire rated lobby construction in upper floors only.

In upper floors D2 and D3 to be fire rated FD20 and self closing. D5 to be FD20.

Stud Wall Finish to align with Structural Wall finish where appropriate.

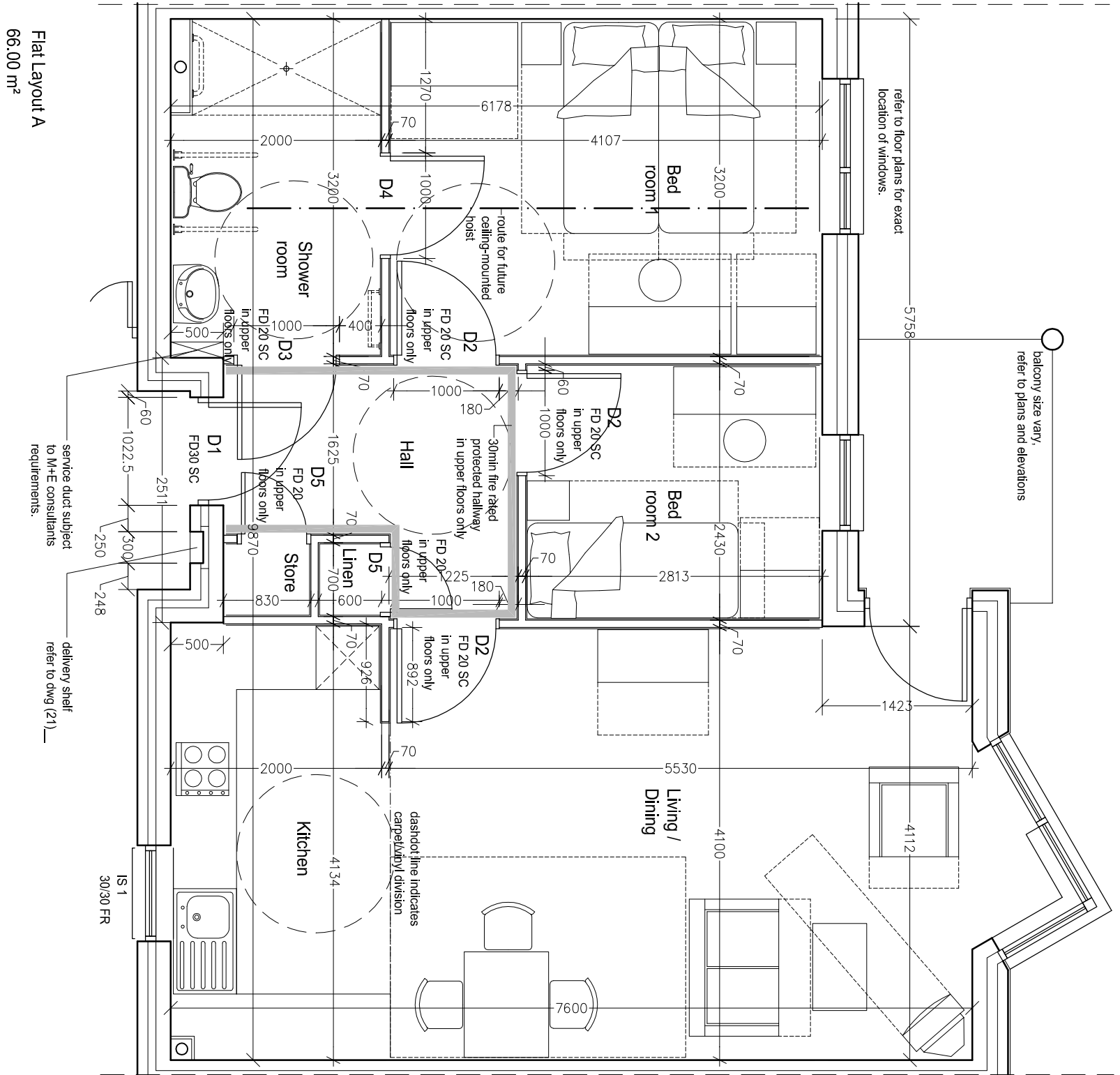

rev	by	date	revision	cd.
B	nvdg	01/07/05	Note for fire rated lobby and fire rated doors in upper floors added, delivery shelf moved,	
A	nvdg	06/06/05	corridor window reference changed from 60/30 FR to 30/30 FR as required by Building Control consultant, fire lobby indicated	

**For Approval**

**limitation of responsibilities**  
 this drawing is not to be scaled.  
 the scope of the architects work is limited to the production of drawings and information leading to the commencement of work on site.  
 the architects are not responsible for the administration of the contract nor the quality of work on site.  
 decisions that are essential to the implementation of the construction on site are to be at the sole risk and discretion of the contractor and no responsibility is taken in contract or tort for any such decision.  
 the accuracy of 'as built' information is reliant upon the quality and completeness of the information provided by the main contractor.

## Pellipar Close Typical Flatlayout A 2 Bed 3 Person

date	drawn	scale	@	cd.
28/01/05	nvdg	1/50		
job number	drawing number	revision		
0417	(2-) 01	B		



10 - 18 Vestry Street  
 London N1 7RE  
 t: 020 7251 5573  
 f: 020 7251 5574  
 london@mepk.co.uk  
 www.mepk.co.uk