

REVISIONS:
 Rev A - 20-11-2013 - 3b unit position adjusted, Blue line updated.

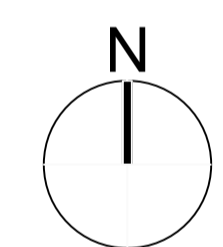
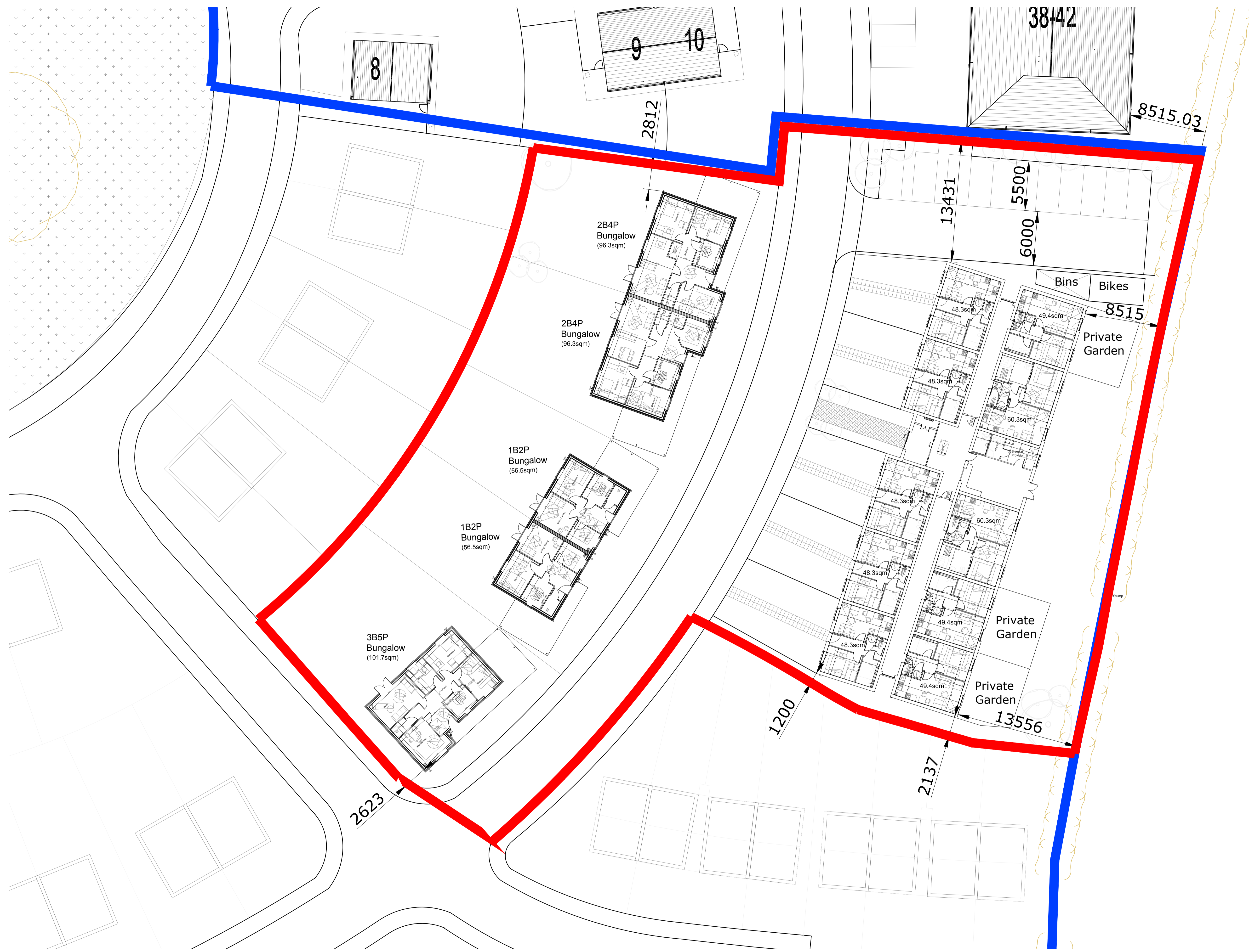

Architects | Masterplanners
STEPHEN GEORGE & PARTNERS LLP
 170 London Road
 Leicester LE2 1ND
 t: 0116 247 0557 f: 0116 254 1095
 www.stephengeorge.co.uk

Proposed residential development
 Manor Farm Phase 2
 SITE PLAN

Drawing status:	PLANNING
CAD reference:	13-067 P
Drawn:	np
Team:	kc
Date:	Oct 2013
Scale:	1:200@ A1

Project no:	Dwg no:	Rev:
13-067	P002	A

This drawing, the works and concepts depicted are copyright of Stephen George & Partners and may not be reproduced or made use of, either directly or indirectly without express written consent. Do not scale off this drawing. All heights, levels, sizes and dimensions to be checked on site before any work is put to hand.