

**SCHEDULE OF ACCOMMODATION  
EXTRA CARE HOUSING FOR THE ELDERLY**

GROUND FLOOR - 8 X 1 BED, 1 X 2 BED & Communal Areas  
 FIRST FLOOR - 13 X 1 BED, 1 X 2 BED & Communal Areas  
 SECOND FLOOR - 5 X 1 BED  
 TOTAL - 26 FLATS (26 X 1 BED, 2 X 2 BEDS)

**GROSS INTERNAL FLOOR AREA**

GROUND FLOOR - 1255 m<sup>2</sup>  
 FIRST FLOOR - 1195 m<sup>2</sup>  
 SECOND FLOOR - 425 m<sup>2</sup>

TOTAL - 2875 m<sup>2</sup>

TOTAL CAR PARKING SPACES 11 & 1 SERVICE BAY

SITE AREA 0.38Ha (0.9 acres)

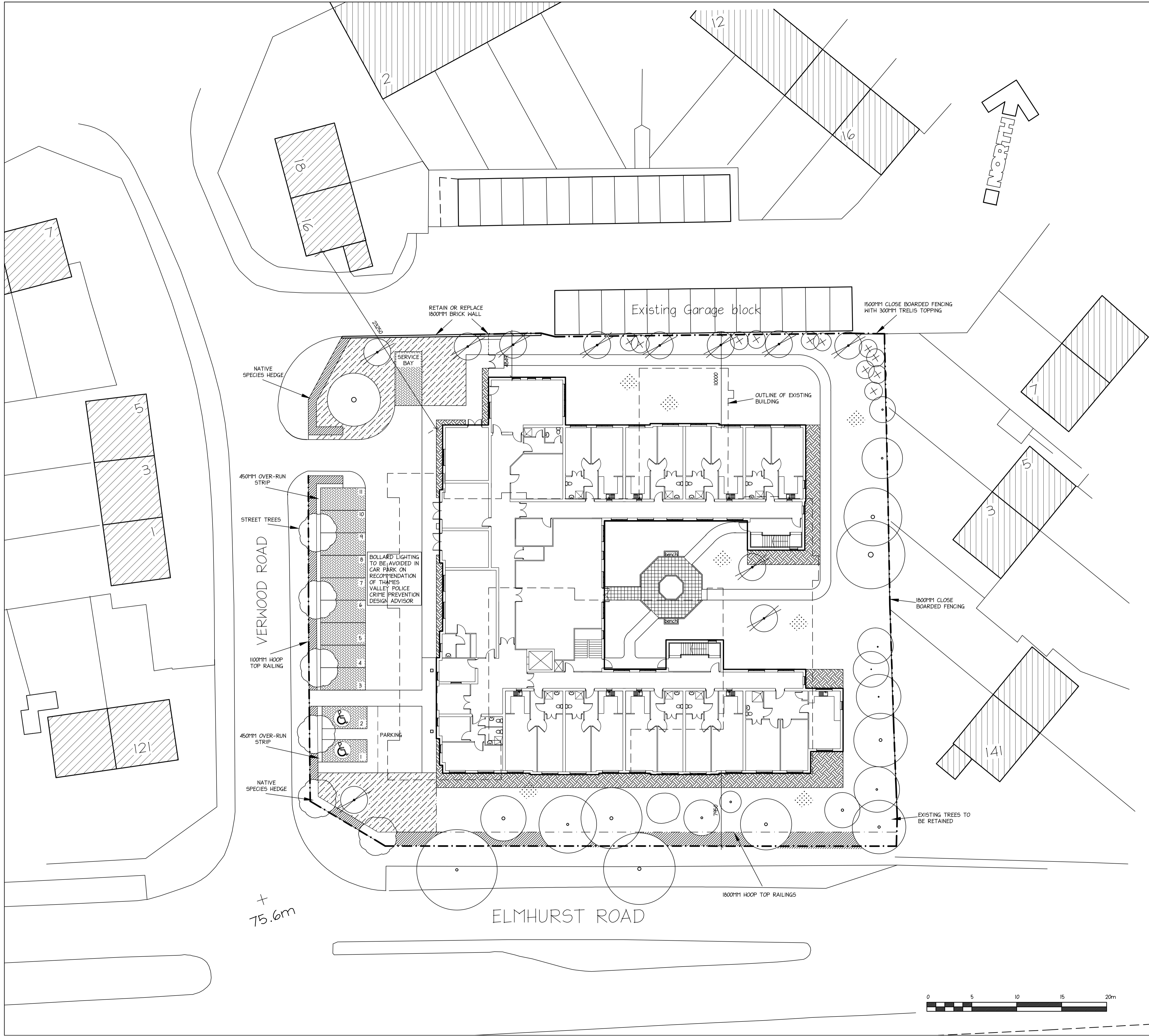

**KEY**

- Existing tree retained
- Large Shrubs  
Syringer pubescens subsp. microphylla 'Superba'  
Abelia floribunda  
Cytisus Battandier  
Choisya ternata 'Sundance'
- New tree to be typically:  
Acer pensylvanicum,  
Betula Pendular,  
Cedrus Deodara "Aurea",  
Tilia euchlora
- Grassed areas
- Tarmac road to Engineers spec  
Tarmac foot paths with timber edging  
Tarmac parking to residential units (to Engineers spec)
- Conc. black paviers - colour brindle
- Marshalls Saxon Buff paving slabs
- Native species hedge
- Meidland Rosa Ground Cover 3/sq M  
Meidland flower rose, semi & ground cover in mixes of White, Pearl & Bingo
- Shrubs and climbers

C	CHANGES TO INCORPORATE LANDSCAPE OFFICERS COMMENTS	29.01.10	M1	
B	CHANGES TO INCORPORATE CRIME PREVENTION ADVISE	15.12.09	M1	
A	PLANNING APPLICATION	03.12.09	M1	
Rev.	Revision	Date	Drawn	Checked

**Carless & Adams Partnership**  
 Architects, Building Surveyors, Quantity Surveyors,  
 Project Managers, Planning Supervisors

6 Progress Business Centre, Whittle Parkway,  
 Bath Road, Slough, Berkshire SL1 6DQ

Tel: 01628 665131  
 Fax: 01628 663327  
 e-mail: cap@carless-adams.co.uk

Client **HOUSING SOLUTIONS GROUP**  
 Project **THE ELMS REDEVELOPMENT**  
 Location **VERWOOD ROAD, AYLESBURY**  
 Title **SITE PLAN**

Scale	A1@:200	Date	NOV 09	Drawn	M1	Checked	
-------	---------	------	--------	-------	----	---------	--

Client no.	Job no.	Drawing no.	Revision
	A-565	21	C

For construction purposes dimensions shall not be scaled & figured dimensions must be verified on site before work commences. This drawing is copyright ©