

# site layout - as proposed

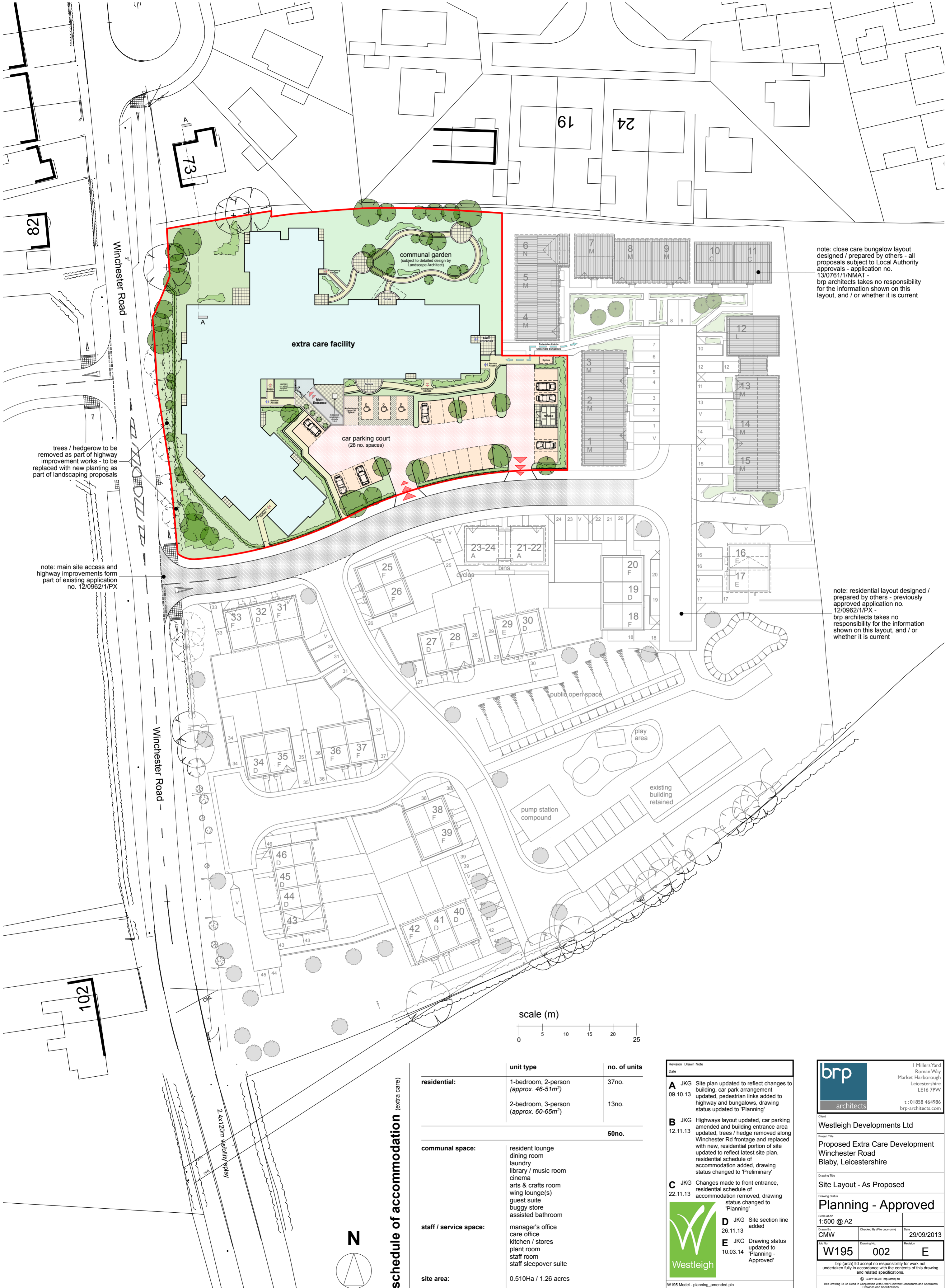

note: close care bungalow layout designed / prepared by others - all proposals subject to Local Authority approvals - application no. 13/0761/1/NMAT - brp architects takes no responsibility for the information shown on this layout, and / or whether it is current

note: residential layout designed / prepared by others - previously approved application no. 12/0962/1/PX - brp architects takes no responsibility for the information shown on this layout, and / or whether it is current

trees / hedgerow to be removed as part of highway improvement works - to be replaced with new planting as part of landscaping proposals

note: main site access and highway improvements form part of existing application no. 12/0962/1/PX

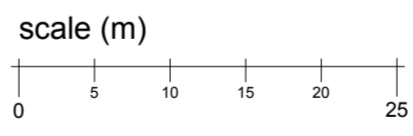

## schedule of accommodation (extra care)

	unit type	no. of units
<b>residential:</b>	1-bedroom, 2-person (approx. 46-51m <sup>2</sup> )	37no.
	2-bedroom, 3-person (approx. 60-65m <sup>2</sup> )	13no.
		<b>50no.</b>
<b>communal space:</b>	resident lounge dining room laundry library / music room cinema arts & crafts room wing lounge(s) guest suite buggy store assisted bathroom	
<b>staff / service space:</b>	manager's office care office kitchen / stores plant room staff room staff sleepover suite	
<b>site area:</b>	0.510Ha / 1.26 acres	

Revision	Drawn	Note
A	JKG	09.10.13 Site plan updated to reflect changes to building, car park arrangement updated, pedestrian links added to highway and bungalows, drawing status updated to 'Planning'
B	JKG	12.11.13 Highways layout updated, car parking amended and building entrance area updated, trees / hedge removed along Winchester Rd frontage and replaced with new, residential portion of site updated to reflect latest site plan, residential schedule of accommodation added, drawing status changed to 'Preliminary'
C	JKG	22.11.13 Changes made to front entrance, residential schedule of accommodation removed, drawing status changed to 'Planning'
D	JKG	26.11.13 Site section line added
E	JKG	10.03.14 Drawing status updated to 'Planning - Approved'

brp  
architects

1 Millers Yard  
Roman Way  
Market Harborough  
Leicestershire  
LE16 7PV  
t: 01858 464986  
brp-architects.com

---

Client: Westleigh Developments Ltd

Project Title: Proposed Extra Care Development Winchester Road Blaby, Leicestershire

Drawing Title: Site Layout - As Proposed

Drawing Status: **Planning - Approved**

Scale: 1:500 @ A2

Drawn By: CMW | Checked By: (file copy only) | Date: 29/09/2013

Job No.: W195 | Drawing No.: 002 | Revision: E

brp (arch) Rd accept no responsibility for work not undertaken fully in accordance with the contents of this drawing and related specifications.  
© COPYRIGHT sup jarkn 18  
This Drawing To Be Read In Conjunction With Other Relevant Consultants and Specialist Drawings And Specifications